



## LUMI Pint-01

IP  
65

Standard outdoor dot pixel lighting (dot light) system, designed for the realization of self-luminous lighting effects for building facades and structural surface. It uses different installation accessories to bring out the ideal combination of curtain wall structures. Optical design, special asymmetric light distribution design not only ensures the brightness of the surface, but also reduces light pollution by decreasing the light output above the horizontal direction, which economically saves energy by improving the utilization of overall light output.

### FEATURES:

Dimension	Ø20mm x H 12.5 mm
Chips	SMD5050 LED
CCT	RGBW
Wattage	0.5W
LED Lifetime	50000 hours
Input Voltage	5V DC
Control	On-off/DMX512
Working Temperature	-20°C to +55°C
Weight	15G
Beam Angle	120° / 160°

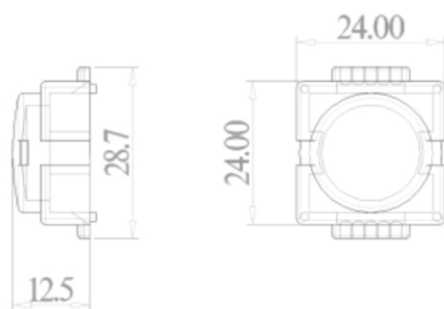
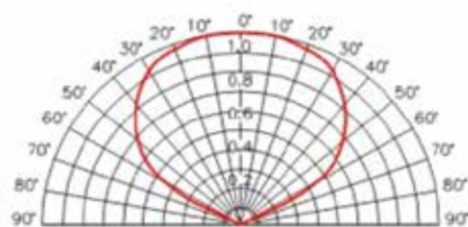

### FEATURES:

Dimension	35 x 45 x 16 mm
Chips	SMT5050 LED
CCT	RGBW
Wattage	1.44W
LED Lifetime	50000 hours
Input Voltage	24V DC
Control	On-off/DMX512
Working Temperature	-20°C to +55°C
Weight	39G
Beam Angle	120° / 160°

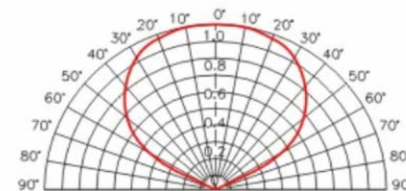

## Pint-02

IP  
65

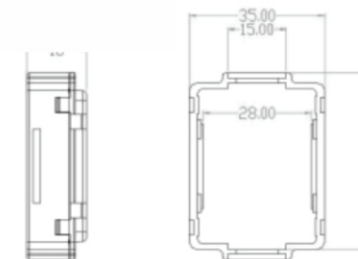

### FEATURES:

Dimension	Ø40mm x H 16 mm
Chips	SMT5050 LED
CCT	RGBW
Wattage	1.44W
LED Lifetime	50000 hours
Input Voltage	24V DC
Control	On-off/DMX512
Working Temperature	-20°C to +55°C
Weight	35G
Beam Angle	120° / 160°

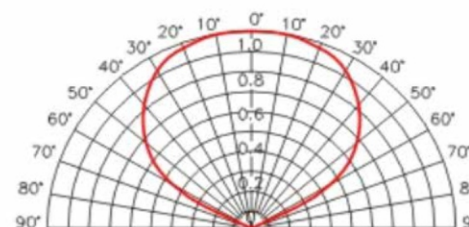

## Pint-03

IP  
65

